

# eureka!®

*Invented for the way you clean™*

## Cordless, Rechargeable VACUUM CLEANER

Household Type

### Owner's Guide Model 79 Series

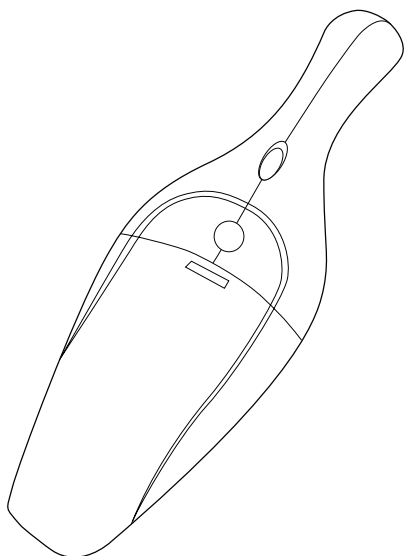

Charge 14-16 hours  
before first use.

### **IMPORTANT**

**Please do not return this  
product to the store.**

**For assembly problems or  
questions contact:** Eureka's  
Customer Service Division  
toll free at 1-800-282-2886\*,  
8 a.m. to 7:30 p.m.,  
Central Standard Time,  
Monday through Friday.  
Saturday and Sunday  
10:00 a.m. - 6:30 p.m.

**For replacement of broken or  
missing items**  
to be shipped direct to you,  
call 1-800-282-2886\*,

**\*En Mexico llame al (55) 5343-4384**

### **Index**

Important Safeguards .....	2
Service Information .....	4
Assembly .....	5-6
Use .....	7
Dust Cup .....	7
Motor Filter .....	8
Battery Disposal .....	8
Customer Order Form .....	9
Warranty .....	11-12

#### **Promotional Code: eurekaad2**

Special offer - receive 15% off parts and  
accessories when ordering online.  
Promotion excludes vacuums.

#### **Código Promoción: eurekaad2**

Oferta especial - descuento 15% off cuando  
compa partes y accesorios el internet.  
Oferta excluye aspiradoron.

**For location of nearest Eureka  
Warranty Station or Service  
Information, call 1-800-282-2886.**

# IMPORTANT SAFEGUARDS

When using an electric appliance, basic precautions should always be followed, including the following:

**READ ALL INSTRUCTIONS BEFORE USING THIS VACUUM CLEANER.**

## WARNING

To reduce the risk of fire, electric shock, or injury:

- Do not use outdoors or on wet surfaces.
- Do not operate the vacuum cleaner or charger that has been damaged in any way. If vacuum cleaner is not working as it should, has been dropped, damaged, left outdoors, or dropped into water, return it to a service center.
- To avoid excessive heat and damage to the unit or batteries, do not operate the vacuum cleaner while in the charging stand.
- Do not allow to be used as a toy. Close attention is necessary when used by or near children.
- Use only as described in this manual.
- Use only the charger provided to recharge; Eureka model A7400 for 120 volt and HKA-A0740 for 230 volt.
- Do not pull or carry the charger by cord, use cord as a handle, close a door on cord, or pull cord around sharp edges or corners. Keep cord away from heated surfaces.
- Do not use extension cords or outlets with inadequate current carrying capacity.
- Do not unplug by pulling on cord. To unplug, grasp the charger, not the cord.
- Do not handle charger or vacuum cleaner with wet hands.
- **DO NOT MUTILATE OR INCINERATE BATTERIES AS THEY WILL EXPLODE AT HIGH TEMPERATURES.**
- Leaks from battery cells can occur under extreme usage or temperature conditions. If the liquid gets on the skin (1) wash quickly with soap and water or (2) neutralize with a mild acid such as lemon juice or vinegar. If the liquid gets into the eyes, flush them immediately with clean water for a minimum of 10 minutes. Seek medical attention. NOTE: The liquid is a 25-35% solution of potassium hydroxide.
- The terminal on the vacuum cleaner should be kept free and clean of objects. While there is no shock hazard from the terminal, a burn could occur if metal objects are inserted into the terminal area.
- This vacuum cleaner creates suction. Keep hair, loose clothing, fingers, and all parts of body away from openings and moving parts.
- Do not pick up anything that is burning or smoking, such as cigarettes, matches, or hot ashes.
- Do not use without a filter in place. When servicing the unit, never put fingers or other objects into the fan chamber in case the unit would accidentally be turned on.
- Use extra care when cleaning on stairs.
- Do not use to pick up flammable or combustible liquids such as gasoline, or use in areas where they may be present.
- Locate the wall bracket indoors in a cool, dry area not exposed to the weather to avoid electrical shock and/or cleaner damage.
- Keep your work area well lighted.
- Unplug electrical appliances before vacuuming them.

**SAVE THESE INSTRUCTIONS**

# CONSEILS DE SÉCURITÉ

Lors de l'utilisation d'un appareil électrique, quelques précautions élémentaires doivent être observées, incluant les suivantes:

**LISEZ TOUTES LES INSTRUCTIONS AVANT D'UTILISER VOTRE ASPIRATEUR.**

## AVERTISSEMENT

Pour réduire le risque de feu, de choc électrique ou de blessure:

- N'utilisez pas l'aspirateur à l'extérieur ou sur une surface mouillée.
- N'utilisez jamais l'aspirateur ou le chargeur s'ils ont été endommagés. Si l'aspirateur ne fonctionne pas comme il le faut, s'il a été échappé, s'il a été endommagé, s'il a été laissé à l'extérieur, s'il a été échappé dans de l'eau, retournez-le à un centre de service avant de l'utiliser.
- Pour éviter que l'aspirateur surchauffe, ou que l'aspirateur ou les piles soient endommagés, n'utilisez pas l'aspirateur lorsqu'il est encore dans son support de recharge.
- Ne permettez pas que l'aspirateur soit utilisé comme un jouet. Une attention particulière est nécessaire lorsqu'il est utilisé par ou près d'un enfant.
- Suivez les recommandations d'utilisation de ce manuel.
- Pour recharger l'aspirateur, utilisez uniquement le chargeur qui l'accompagne – Eureka modèle n° A7400 pour 120 volt, HKA-A0740 pour 230 volt.
- Ne pas tirer l'aspirateur ou le transporter par le cordon. Ne pas utiliser le cordon en guise de poignée. Ne pas fermer une porte sur le cordon ou tirer le cordon sur des bordures ou des coins pointus. Tenir le cordon à distance des surfaces chauffantes.
- Ne pas utiliser des rallonges ou des prises qui n'ont pas une capacité suffisante pour transporter le courant.
- Ne pas débrancher en tirant sur le cordon. Pour débrancher, empoignez le chargeur et non pas le cordon.
- Ne pas manipuler le chargeur ou l'aspirateur avec les mains mouillées.
- **NE PAS MUTILER OU INCINÉRER LES PILES. LES PILES EXPLOSENT A DES TEMPERATURES EXCESSIVES.**
- Il peut y avoir des fuites des éléments des piles lorsque celles-ci sont soumises à des conditions d'emploi excessif ou de température excessive. Si le liquide touche la peau (1) laver tout de suite la peau avec de l'eau et du savon (2) Neutraliser avec un acide doux, tel que le jus de citron ou le vinaigre. Au cas de contact avec les yeux, nettoyer à grande eau pour un minimum de 10 minutes. Cherchez des soins médicaux. NOTE: Le liquide est une solution à 25-35% d'hydroxyde de potassium.
- La borne de l'aspirateur doit être maintenue propre et libre de tout autre objet. Il n'y a aucun risque de choc électrique de la borne elle-même, mais une brûlure est possible si des objets en métal sont introduits dans la borne.
- Cet aspirateur crée de la suction. Tenir les parties mobiles et les ouvertures loin des cheveux, des habits, des doigts et de toute partie du corps.
- Ne pas ramasser des objets qui brûlent ou fument comme des cigarettes, des allumettes ou les cendres chaudes.
- Ne pas utiliser sans que le filtre ne soit installé. Lors de réparations ou d'entretien, il ne faut jamais mettre les doigts, ou autres objets, près du ventilateur dans le cas où l'aspirateur serait accidentellement mis en marche.
- Portez une attention particulière lorsque vous nettoyez les escaliers.
- Ne pas utiliser pour ramasser des liquides inflammables ou combustibles comme de l'essence. Ne pas utiliser dans les endroits où ces liquides pourraient être présents.
- Situez le support pour l'aspirateur à l'intérieur, dans un endroit frais, sec et protégé pour éviter le choc électrique ou les dommages.
- Travaillez toujours dans un endroit bien éclairé.
- Débranchez les appareils électriques avant de les nettoyer avec l'aspirateur.

**CONSERVEZ CES INSTRUCTIONS**

## GENERAL INFORMATION

The cordless vacuum cleaner is the answer for quick, convenient, and easy cleanups. Grab the cleaner for little tasks rather than using a larger cleaner. Place the wall bracket in any area of easy access that allows versatile cleaning of kitchen crumbs, window sills, or steps. Always store the cleaner in the wall bracket to provide a ready charge.

**Charge for 14-16 hours before first use.  
Batteries could lose charge in shipping.**

It is best to charge the batteries when temperatures are between 32°F (0°C) and 104°F (40 C). Other temperatures could damage batteries.

While charging, the charger may become warm to the touch. This is a normal condition and does not indicate a problem.

## Important Battery Disposal Information

### Nickel-Cadmium Batteries



The RBRC Battery Recycling Seal on the nickel-cadmium (Ni-Cd) battery indicates The Eureka Company is voluntarily participating in an industry program to collect and recycle these batteries at the end of their useful life, when taken out of service in the United States or Canada. The RBRC program provides a convenient alternative to placing used Ni-Cad batteries into the trash or the municipal waste system, which is illegal in some areas. Please call 1-800-8-BATTERY for information on Ni-Cd battery recycling in your area.

**NOTE: Remove the battery pack only when the batteries no longer hold a charge and you plan to dispose of them.**

## Service Information

The instructions in this booklet serve as a guide to routine maintenance. If additional service is required, telephone toll free:

**USA: 1-800-282-2886  
Mexico: (55) 5343-4384  
Canada: 1-800-282-2886**

for the nearest Eureka Authorized Warranty Station. If you prefer, you can write to Electrolux Home Care Products North America, Service Division, P.O. Box 3900, Peoria, IL 61612. In Canada write to Electrolux Home Care Products North America, 5855 Terry Fox Way, Mississauga, Ontario L5V3E4. Refer to The Eureka Warranty for complete service information.



**DO NOT OIL.** The motor has lubrication and has a permanent seal.

## Rating Plate

The model number is indicated on the rating plate which is located on the underside of the vacuum cleaner. For prompt and complete service, always refer to these numbers:

Model and Type No. \_\_\_\_\_

Serial No. or Date Code \_\_\_\_\_

ELECTROLUX HOME CARE PRODUCTS  
NORTH AMERICA  
Bloomington, Illinois 61701 USA  
HOUSEHOLD TYPE

MODEL

## Identify Parts

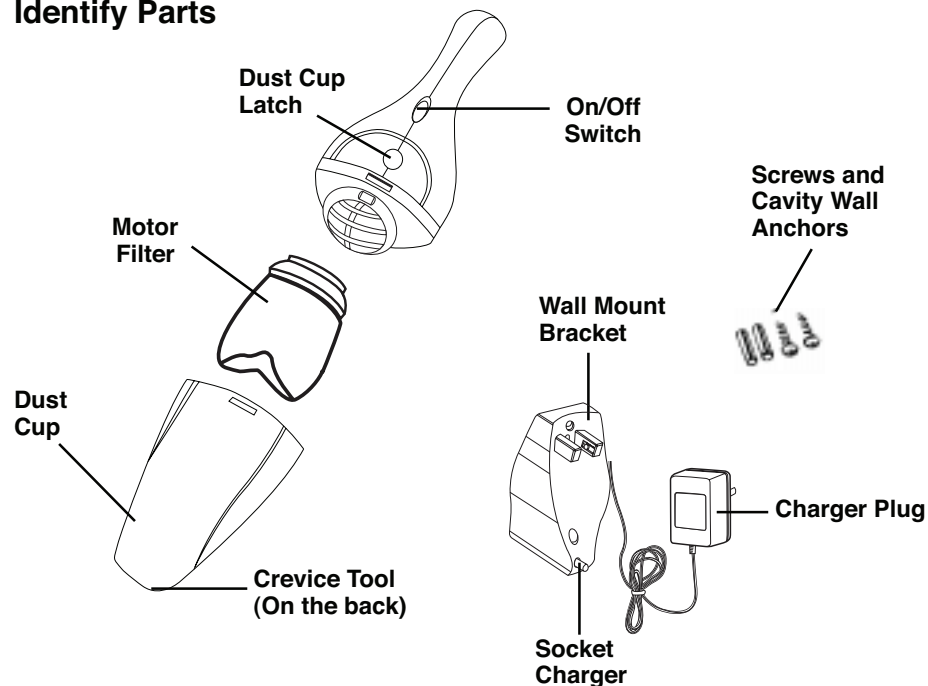

## USING THE VACUUM CLEANER

1. To switch on, move the on/off switch forward toward the dust container.
2. To switch off, move the on/off switch backward toward the handle.

## To Use the Crevice Tool

1. Locate crevice tool on the bottom of the cleaner.
2. Grasp the end of the crevice tool nozzle and rotate out until it stops.
3. Then push the crevice tool firmly into the end of the cleaner nozzle.

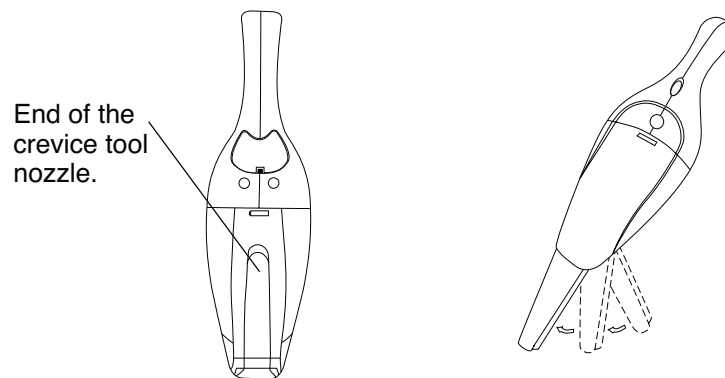

4. After use, to store crevice tool pull the crevice tool out from the cleaner nozzle.
5. Rotate back into the bottom of the cleaner until it snaps into place.

## How to Wall Mount your Wall Bracket

**CAUTION: Use only charger model A7400 for 120 volt; model HKA-A0740 for 230 volt.**

Your vacuum cleaner has a special bracket designed to hold the unit, so that it may recharge while mounted on the wall.

Cleaner hangs in bracket with the nozzle end down. Mount on a wall where there are no dangerous objects hidden beneath the wall surface like electrical wires, pipes, etc.

1. Hold bracket against wall to mark location for screws. Make sure the wall bracket is positioned vertically, with the charger socket at the bottom.
2. Use a 1/4 inch drill for drilling holes for the plastic anchors.
3. Insert the anchors. Line up the bracket with the anchors.
4. Use a screwdriver to drive the screws into the anchors to secure the bracket.

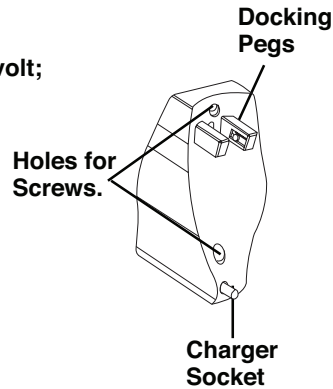

## How to Mount your Vacuum Cleaner

5. Rest the cleaner on the docking pegs, with the nozzle pointed down push on the unit until you hear the charger socket click into place.
6. Plug the charger into an electrical outlet.

**NOTE: Charge the cleaner for 14-16 hours before initial use. The batteries of a new cleaner are on a low charge.**

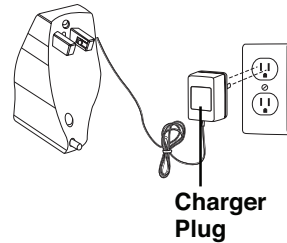

## How to Switch Optional Charger Plug

1. Remove the screw in the middle of the back of the wall bracket and remove back cover.
2. Unwind the cord from cord holders and pull charger socket up and away from wall bracket.
3. Insert new charger socket into charger socket hole and wind cord around cord holders.
4. Replace back cover lining cord up with notch in back cover. Replace screw.

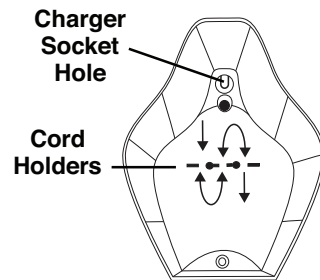

## Keeping your Vacuum Cleaner Ready for Use

Return your vacuum cleaner to the wall holder after every use. Firmly position into the mounting bracket ensuring that the vacuum cleaner fits correctly into the charging socket. It will then be recharged and ready for operation at all times.

The charger plug can be left in the electrical outlet at all times, even when the unit is in use. It is impossible to overcharge the batteries. The charger plug will become warm, however, this is not a cause for concern.

## HOW TO USE

1. Push the power switch forward to turn on.
2. Pull the power switch back to turn off.

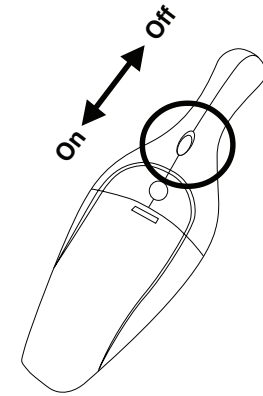

## HOW TO MAINTAIN

The instructions given in this booklet serve as a guide to routine maintenance. Keep the cleaner operating at top efficiency. Empty the dust cup and clean the filter after each use.

## Empty Dust Cup

1. Push down on dust cup latch.
2. Pull dust cup from handle section.
3. Remove motor filter from dust cup.
4. Shake contents into a waste container.
5. Clean motor filter (refer to motor filter section, page 8).
6. Replace motor filter in the dust cup.
7. Press dust cup onto handle section until they snap together.

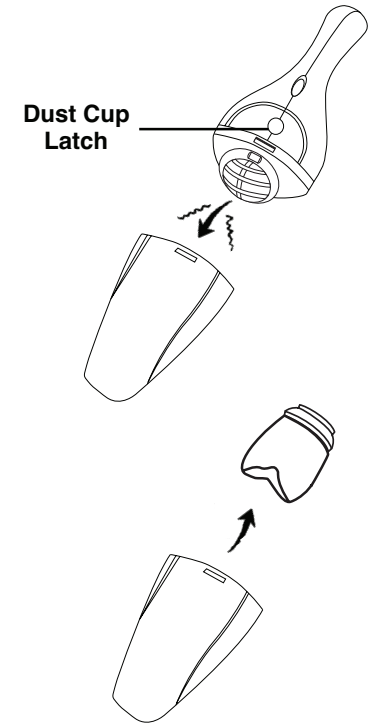

## Clean Motor Filter

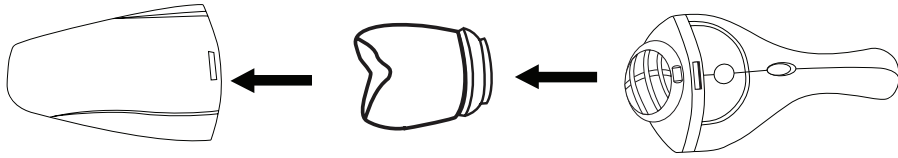

Clean the motor filter after each cleaner use.

1. Remove the filter frame from the dust cup.
2. Shake and brush the dust and dirt from filter.
3. If desired, remove filter from filter frame and launder the filter by hand in warm water (150°F, 65°C) using a mild detergent.
4. Air dry thoroughly.
5. Replace filter over frame.

Replace a dirty or torn filter. Order additional motor filters from Electrolux Home Care Products North America, Bloomington, IL 61701.

Order motor filter, 61130.

## Remove Battery Pack for Disposal



For information 1-800-822-8837

**NOTE:** Remove the battery pack only when the batteries no longer hold a charge and you plan to dispose of them.

**CAUTION:** Do not short circuit or dispose of in fire. Dispose of properly.

A municipal waste will not dispose of the battery pack. Use a recycling center if one is convenient. Otherwise, take or send the battery pack to your nearest Eureka Warranty Service Station. To learn the address of the nearest factory service center call 1-800-282-2886.

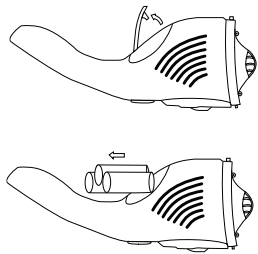
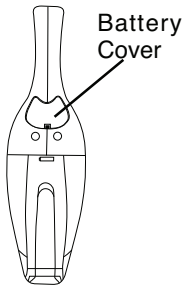

1. Lay cleaner down on its top.
2. Use a screwdriver to pry the battery cover up and away from unit.
3. Remove battery pack and dispose of properly. **For more information call 1-800-822-8837.**

# eureka!

For orders in US  
Para pedidos en los EE.UU.

## PARTS ORDER FORM FORMULARIO DE PEDIDO DE PIEZAS



[www.EUREKA.com](http://www.EUREKA.com)

For faster service, visit us Online  
Para obtener un servicio más rápido,  
haga los pedidos por Internet



By Phone: 1-800-282-2886  
Por Teléfono:

HOURS: call Monday-Friday, 8 am-7:30 pm CST; Saturday and Sunday, 10 am-3:30 pm CST  
Please call the same number for answers to problems or questions in the USA and Canada  
HORARIOS: Llame de lunes a viernes de 8 am a 7:30 pm CST y sábados y domingos de 10 am a 3:30 pm CST (Llame a este mismo número para consultas o preguntas en EE.UU. y Canadá)

Genuine Eureka Accessories, Bags, Belts and Filters  
Accesorios, bolsas, correas y filtros legítimos Electrolux

	Part No. Nº de parte	Qty. Cant.	Price/qty. Precio (usd*)	Total Total
	61130		\$2.99	
MOTOR FILTER WITH FRAME FILTRO DE MOTOR CON BASTIDOR				
	70686		\$6.99	
CHARGER (110 VOLT) CARGADOR (110 VOLTIOS)				
	70685		\$19.49	
BATTERY PACK BLOQUE DE ALIMENTACION				

TOTAL: \*prices subject to change without notice  
TOTAL: precios sujetos a modificación sin previo aviso

TAX: (add state tax and local taxes as required by law)  
IMPUESTOS: (agregar el impuesto estatal y los impuestos locales según las leyes)

POSTAGE AND HANDLING CHARGE / GASTOS DE ENVÍO

TOTAL ENCLOSED (A + B + C = D) / TOTAL INCLUIDO (A + B + C = D)

Printed in China  
Impreso en China

PN 78043A (1/10)

©2010 Electrolux Home Care Products, Inc.

**IMPORTANT / IMPORTANTE**

MODEL NUMBER / NÚMERO DE MODELO

TYPE / TIPO

SERIAL NUMBER / NÚMERO DE SERIE

Be sure to include your model, type and serial numbers. These numbers may be found on the rating plate. Asegúrese de incluir los números de modelo, tipo y serie. Estos números se encuentran en la placa de datos.

### By Mail: / Por Correo:

Simply fill out this Order Form. Please be sure to include your phone number.  
Llene simplemente este formulario de pedido. Asegúrese de incluir su número telefónico.

### SHIP TO: / ENVIAR A:

Name / Nombre

Address / Dirección

City / Ciudad

State / Estado

Zip Code / Código Postal

Telephone (Very Important) / Teléfono (Muy Importante)

### PAYMENT: / PAGO:

(no C.O.D. Orders (no se aceptan pedidos de pago contra entrega))

Check or money order. Do not send currency.

Cheque o giro postal. No envíe dinero en efectivo.

VISA  DC  MC  AMEX

ACCT. NUMBER / NÚMERO DE CUENTA

EXPIRATION DATE / FECHA DE VENCIMIENTO

SIGNATURE (full name as shown on acct.)  
FIRMA (nombre completo como aparece en la cuenta)

### PAYABLE TO: / PAGADERO A:

Electrolux Home Care Products, Inc.  
P.O. Box 3900  
Peoria, IL 61612





For orders in Canada  
Pour les commandes au Canada

## PARTS ORDER FORM FORMULAIRE DE COMMANDE DE PIÈCES



[www.EUREKA.com](http://www.EUREKA.com)

For faster service, visit us Online  
Pour un service plus rapide,  
passez nous voir en ligne



By Phone: 1-800-282-2886  
Au téléphone :

HOURS: Call Monday-Friday, 8 am-7:30 pm (CST, Saturday and Sunday, 10 am-5:30 pm)  
CST. Please call the same number for answers to problems or questions in the USA and Canada.)  
HEURES: Appelez du lundi au vendredi de 8 h à 19 h, 30. Heure Normale du Centre et le samedi et dimanche de 10 h à 18 h, 30 Heure Normale du Centre. Veuillez appeler le même numéro aux États-Unis et au Canada pour les réponses aux problèmes ou questions.

Genuine Eureka Accessories, Bags, Belts and Filters  
Accessoires, sacs, courroies et filtres Electrolux authentiques

	Part No. N° de pièce	Qty. Qté.	Price(CAD) * Prix(\$A) *	Total Total
	MOTOR FILTER WITH FRAME MOTEUR DE FILTRE AVEC UN CADRE	61130	*	
			see below voir ci-dessous	
	CHARGER (110 VOLT) CHARGEUR DE BATTERIE	70686	*	
			see below voir ci-dessous	
	BATTERY PACK BATTERIE	70685	*	
			see below voir ci-dessous	



For pricing, see our website or call / Pour la tarification, voyez notre site web ou appelez

[www.eureka.com](http://www.eureka.com)

1-800-282-2886

TOTAL: \*prices subject to change without notice  
TOTAL: \*prix sujets à des modifications sans avertissement

TAX: (add state tax and local taxes as required by law)

TAXE: (ajouter les taxes de état et les taxes locales comme cela est exigé par la loi)

POSTAGE AND HANDLING CHARGE / FRAIS DE MANUTENTION ET D'ENVOIS

TOTAL ENCLOSED (A + B + C + D) / TOTAL CH-OINT (A + B + C + D) **\$9.75**

Printed in China  
Imprimé en China

PN 78043A (1/10)

©2010 Electrolux  
Home Care Products, Inc.

### IMPORTANT / IMPORTANT

MODEL NUMBER  
NUMÉRO DE MODÈLE

TYPE  
TYPE

SERIAL NUMBER  
NUMÉRO DE SÉRIE

Be sure to include your model, type and serial numbers.  
These numbers may be found on the rating plate.  
Veuillez à joindre vos numéros de modèle, type et série.  
Ces numéros figurent sur la plaque du constructeur.

**By Mail: / Par Courier:**

Simply fill out this Order Form. Please be sure to include your phone number.  
Remplissez simplement ce bon de commande. Veuillez à joindre votre numéro de téléphone

**SHIP TO: / EXPÉDIEZ À :**

Name / Nom

Address / Adresse

City / Ville

State / Etat Zip Code / Code Postal

Telephone (Very Important) / Téléphone (très important)

**PAYMENT: / PAIEMENT:**

(no C.O.D. Orders) (pas de livraison contre remboursement)

Check or money order. Do not send currency.

Chèque ou mandat. N'envoyez pas d'espèces.

VISA  DC  MC  AMEX

ACCT. NUMBER / NUMÉRO DE COMPTE

EXPIRATION DATE

SIGNATURE (full name as shown on acct.)

SIGNATURE (nom complet tel qu'il apparaît sur le compte)

**PAYABLE TO: / À L'ORDRE DE:**

Electrolux Home Care Products Canada  
5855 Terry Fox Way  
Mississauga, Ontario L5V 3E4

# THE EUREKA LIMITED WARRANTY

## What This Warranty Covers

Your Eureka cleaner is warranted to be free from all defects in material and workmanship in normal household use for a period of one year. The warranty is granted only to the original purchaser and members of his or her immediate household. The warranty is subject to the following provisions.

## What This Warranty Does Not Cover

- Parts of the cleaner that require replacement under normal use.
- Damages or malfunctions caused by negligence, abuse, or use not in accordance with the Owner's Guide.
- Defects or damages caused by unauthorized service or the use of other than Genuine Eureka, ARM & HAMMER™ and Filtrate™ by 3M parts.

## What The Eureka Company Will Do

The Eureka Company will, at its option, repair or replace a defective cleaner or cleaner part that is covered by this warranty. As a matter of warranty policy, the Eureka Company will not refund the consumer's purchase price.

## Warranty Registration

Please fill out and return the warranty registration card accompanying your cleaner.

## Obtaining Warranty Service

To obtain warranty service you must return the defective cleaner or cleaner part along with proof of purchase to any Eureka Authorized Warranty Station. You will find the nearest location in the Yellow Pages, under "Vacuum Cleaners--Service and Repair." Be certain that the Warranty Station is "Eureka Authorized."  
For the location of the nearest Eureka Authorized Warranty Station or for service information, telephone toll free:

**USA: 1-800-282-2886**

**Mexico: (55) 5343-4384**

**Canada: 1-800-282-2886**

If you prefer, you can write to Electrolux Home Care Products North America, Service Division, P.O. Box 3900, Peoria, IL 61612. In Canada write to Electrolux Home Care Products North America, 5855 Terry Fox Way, Mississauga, Ontario, L5V3E4. If it is necessary to ship the cleaner outside your community to obtain warranty repair, you must pay the shipping charges to the Eureka Authorized Warranty Station. Return shipping charges will be paid by the Warranty Station. When returning parts for repair, please include the model, type, and serial number from the data plate on the cleaner.

## *Further Limitations and Exclusions*

Any warranty that may be implied in connection with your purchase or use of the cleaner, including any warranty of Merchantability or any warranty for Fitness For A Particular Purpose is limited to the duration of this warranty. Some states do not allow limitations on how long an implied warranty lasts, so the above limitations may not apply to you.

Your relief for the breach of this warranty is limited to the relief expressly provided above. In no event shall Eureka be liable for any consequential or incidental damages you may incur in connection with your purchase or use of the cleaner. Some states do not allow the exclusion or limitation of incidental or consequential damages, so the above limitation or exclusion may not apply to you.

This warranty gives you specific legal rights. You may also have other rights which vary by state.



## *Questions & Answers about Genuine Eureka Products*

**Q:** Why should I use only Genuine Eureka parts in my Eureka product?

**A:** Using Genuine Eureka Products, which are made to our exacting specifications and engineered with emphasis on quality, performance, and customer satisfaction, ensures the long life and cleaning efficiency of your vacuum cleaner. Overall, this saves you money and helps to keep your home clean.

**Q:** How can I be sure I am using only genuine Eureka products in my product?

**A:** Typically, packaged products and paper bags can be identified by a "Genuine Eureka Product" symbol (see illustration above). For further identification assistance, you may call our toll-free number, 1-800-282-2886, for the location of a nearby Eureka Authorized Warranty Station.

**Q:** Are there any differences between "made to fit" or "imitation" and Genuine Eureka parts?

**A:** Yes, there are some very important differences in materials, quality, and reliability. Many customers have mistakenly purchased "imitation" paper bags and parts while thinking they purchased genuine. Unfortunately, many of these customers discovered the differences after they experienced related difficulties.

**For Genuine Eureka Value, Accept No Limitations!**

Household Warranty  
abs 190